

WBFK-32203-000
SHT 1.1

NOTES:

- 1 A POSITIVE GOING VOLTAGE AT TERMINAL 2, RELATIVE TO TERMINAL 1, CAUSES A DECREASE IN PRESSURE AT THE SOUND OUTLET.
- 2 LOCATED FROM TWO SURFACES FOR CUSTOMER CONVENIENCE. ONLY APPLICABLE FROM ONE SURFACE, NOT TO BE USED TOGETHER.

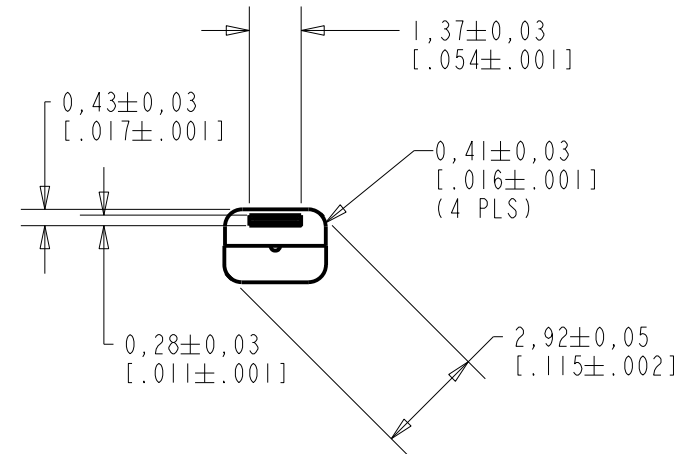
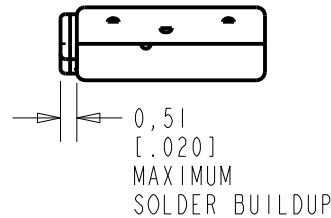
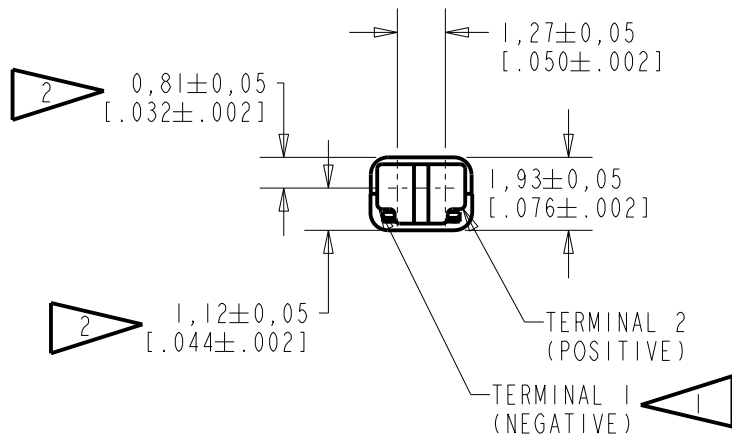
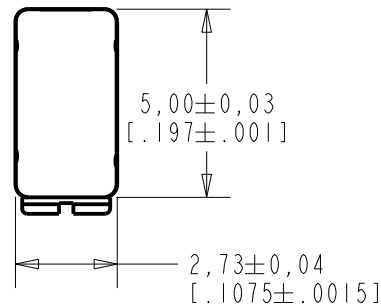

SCALE 2:1
 NOMINAL WEIGHT 0.09 GRAMS
 DIMENSIONS IN MILLIMETERS [INCHES]

KNOWLES ELECTRONICS
 ITASCA, ILLINOIS U.S.A.

Revision	C.O. #	Implementation Date	RELEASE LEVEL	REVISION
			Active	A
A	PI0000112	9-7-15		

SCALE: 5:1		DR. BY: SSUN	DATE: 9-7-15
DO NOT SCALE DRAWING			
TITLE: RECEIVER		WBFK-32203-000	
OUTLINE DRAWING		SHT 1.1	
		CK. BY: GJP	DATE: 9-7-15
		APP. BY: GJP	DATE: 9-7-15

AN UNDAMPED AND TUBELESS MAGNETIC BALANCED ARMATURE RECEIVER WITH TAPERED REED INTENDED FOR USE AS THE HIGH FREQUENCY DRIVER IN A HIFI SYSTEM.

NO DAMPING

WBFK-32203-000

SHEET 2.1

NOTE: SPECIFICATIONS FOLLOWED BY AN ASTERISK (*) ARE 100% TESTED.

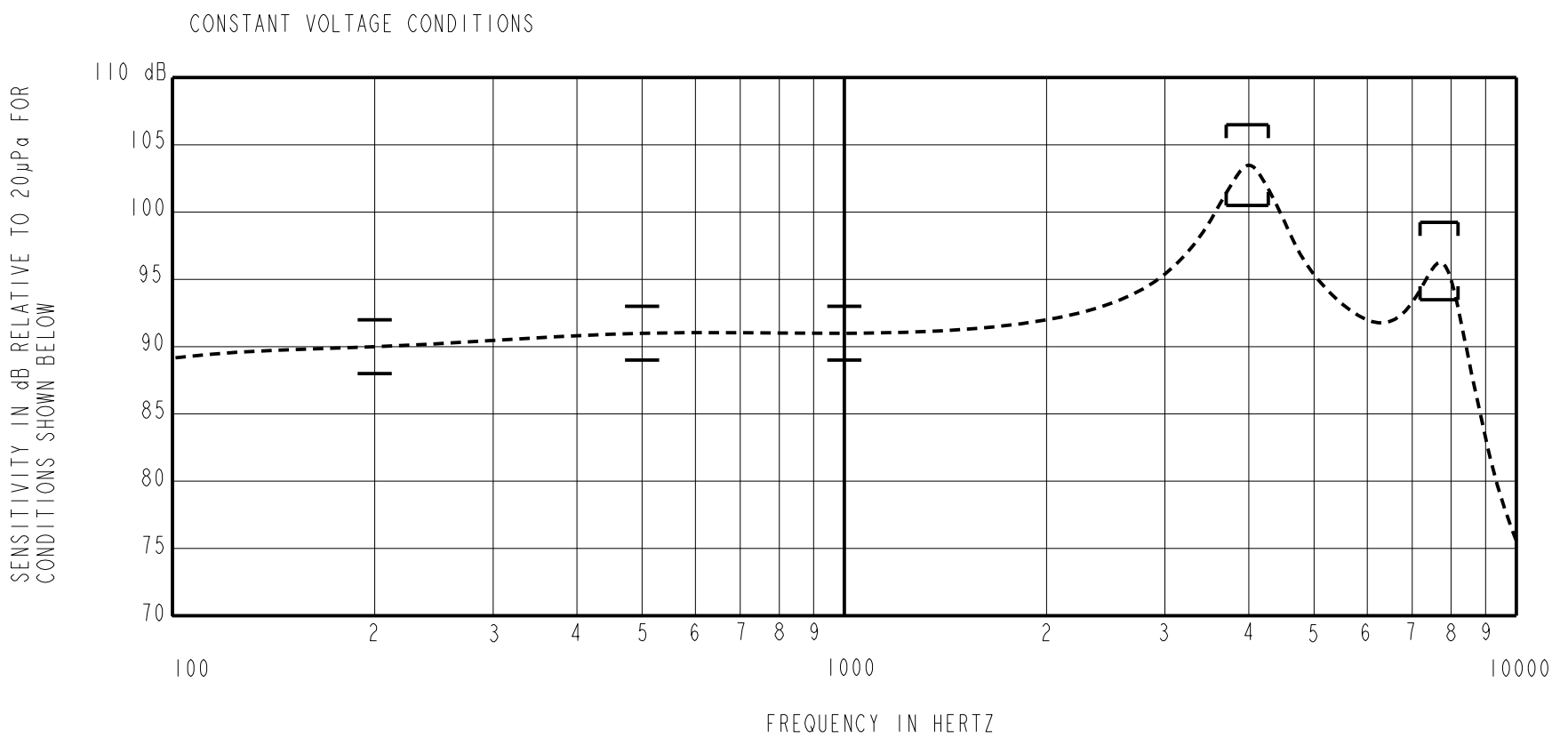

ACOUSTICAL

SENSITIVITY*
 DEVICE WILL PRODUCE THE SPL LISTED BELOW UNDER TEST CONDITION IN TABLE 3.
 NOMINAL SENSITIVITY AT 1kHz IS dB RELATIVE TO 20 μPa. ALL OTHER VALUES
 IN dB RELATIVE TO THE SENSITIVITY AT 1kHz.

FREQUENCY (Hz)	MINIMUM	NOMINAL	MAXIMUM
200	-3.0	-1.0	+1.0
500	-2.0	0.0	+2.0
1000	-2.0	91.0	+2.0
3700-4300	+9.5	+12.5	+15.5
7200-8200	+2.5	+5.5	+8.5

TABLE 1

MECHANICAL

PORT LOCATION: 12N
 SOLDER TYPE: SAC305
 TEMPERATURE
 OPERATING: SENSITIVITY WILL NOT VARY MORE
 THAN +1 / -3 dB FROM -17°C TO 63°C.
 STORAGE: -40°C TO 63°C.

TOTAL HARMONIC DISTORTION*
 DEVICE WILL NOT EXCEED TOTAL HARMONIC DISTORTION LEVELS LISTED BELOW.

FREQUENCY (Hz)	AC DRIVE (V rms)	DC BIAS (V)	LIMIT (%)
1/3 PEAK	.054	0	5
1/2 PEAK	.054	0	5
1/3 PEAK	.152	0	10
1/2 PEAK	.152	0	10

TABLE 2

TEST CONDITIONS

NOMINAL SOURCE VOLTAGE	.054 V rms, 0 mA DC BIAS
SOURCE IMPEDANCE	<1 Ohm
TUBING	10mm [.394"] LONG, 1mm [.039"] I.D.
COUPLER CAVITY	2 CM ³ , SIMULATED ANSI S3.7 TYPE HA-3 (IEC 60318-5)

TABLE 3

ELECTRICAL

DC RESISTANCE	3.8 Ohms ± 10%*
IMPEDANCE @ 500 Hz	4.4 Ohms ± 15%*
IMPEDANCE @ 1kHz	4.6 Ohms ± 15%*

TABLE 4

ISOLATION: CASE WILL BE ELECTRICALLY ISOLATED FROM THE COIL CIRCUIT.

Revision	C.O. #	Implementation Date	RELEASE LEVEL	REVISION
			Active	A
A	PI0000112	9-7-15		
WHEN TEST LIMITS ARE USED TO ESTABLISH INCOMING INSPECTION ACCEPTANCE/REJECTION CRITERIA, CORRELATION OF TEST EQUIPMENT WITH KNOWLES IS ALSO REQUIRED FOR ELIMINATION OF EQUIPMENT AND TEST METHOD VARIATION			DR. BY	DATE
TITLE: RECEIVER PERFORMANCE SPECIFICATION			SSUN	9-7-15
			WBFK-32203-000	
			GJP	9-7-15
			APP. BY	DATE
			GJP	9-7-15

KNOWLES ELECTRONICS
 ITASCA, ILLINOIS U.S.A.